

**ALL FIELDS DETAIL**

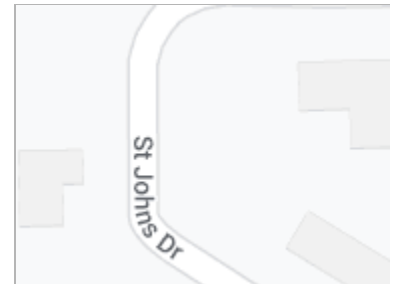

<b>MLS #</b>	33947	<b>LOT SIZE</b>	- 1/2 ACRE
<b>Asking Price</b>	\$39,000	<b>RESIDENCE</b>	YES
<b>Status</b>	ACTIVE	<b>TYPE WATER</b>	CITY
<b>Class</b>	LAND	<b>SEWER</b>	CITY
<b>Type</b>	RESIDENTIAL LOT	<b>GAS</b>	NO
<b>Area</b>	ATKINSON	<b>ELECTRIC</b>	NO
<b>Address</b>	St. John's Drive	<b>FLOOD ZONE</b>	NO
<b>City</b>	Atkinson	<b>VACANT</b>	YES
<b>State</b>	NE	<b>AUCTION</b>	NO
<b>Sale/Rent</b>	For Sale		
<b>IDX Include</b>	Y		



**GENERAL**

<b>VOW Include</b>	Yes	<b>VOW Address</b>	Yes
<b>VOW Comment</b>	Yes	<b>VOW AVM</b>	Yes
<b>Number of Acres</b>	0.26	<b>Price Per Acre</b>	\$150,000.00
<b>Agent</b>	Kellyn Kilmurry - Cell: 402-340-2977	<b>Listing Office 1</b>	Stracke Realty, LLC - Off: 402-340-2990
<b>Sales Broker Compensation</b>	6.5%	<b>Listing Date</b>	4/5/2024
<b>Legal</b>	ATK VI; J.L.P. DEV; BLK 3 LOT 7 (per assessor's website)	<b>ELEMENTARY SCHOOL</b>	West Holt
<b>SCHOOL DISTRICT</b>	West Holt	<b>SQUARE FEET</b>	11376
<b>Associated Document Count</b>	0	<b>Original Price</b>	\$39,000
<b>Update Date</b>	4/17/2024	<b>Status Date</b>	4/17/2024
<b>Hotsheet Date</b>	4/17/2024	<b>Price Date</b>	4/17/2024
<b>Input Date</b>	4/17/2024 1:57 PM	<b>Days On Market</b>	12
<b>Geocode Quality</b>	Manually Placed Pin	<b>Picture Count</b>	9
<b>Input Date</b>	4/17/2024 1:57 PM	<b>Update Date</b>	4/17/2024 1:57 PM
<b>Video Count</b>	0		

**FEATURES**

<b>WATER</b>	<b>LOT LOCATION</b>	<b>SIGN ON PROPERTY</b>
CITY	CORNER	YES
<b>SEWER</b>	CUL-DE-SAC	
CITY	RESIDENTIAL	

**FINANCIAL**

<b>PARCEL #</b> 450020257	<b>TAX YEAR</b> 2023
<b>TAXES</b> \$436.22	

**ADDENDUM**

**Addendum** 0.26 Acre Lot Large size corner lot in a great residential neighborhood in Atkinson, NE. Seize the opportunity to build your dream home, duplex, or shop on this expansive corner lot nestled in one of Atkinson's most sought-after residential neighborhoods. Boasting a desirable location close to schools, parks, pool, and game fields, this parcel of land offers endless possibilities for creating the perfect living space tailored to your lifestyle.

**REMARKS**

**Remarks** 0.26 Acre Lot Large size corner lot in a great residential neighborhood in Atkinson, NE.

**ADDITIONAL PICTURES**

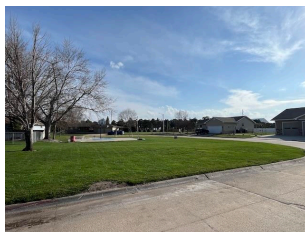
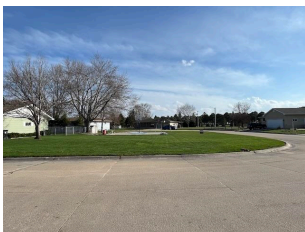

MLS # 33947

Address: St. John's Drive



---

**DISCLAIMER**

This information is deemed reliable, but not guaranteed. All measurements are approximate and should be verified. The listing broker's offer of compensation is made only to Participants of the MLS where the listing is filed.